

# Mid-America Club Private Event



## **BURNHAM BALLROOM A-D**

The largest of our private event spaces, the Burnham Ballroom is located along the south, east and west side of the AON Center. Nearly floor-to-ceiling windows provide beautiful views of Millennium Park, Buckingham Fountain, Grant Park, Navy Pier and the Chicago Skyline. The Ballroom features a variety of floor layouts for galas, wedding receptions, business meetings, social dinners and more.

## **FRANK LLOYD WRIGHT 1 AND 2**

Frank Lloyd Wright 1 and 2 is located on the north side of the Aon Center. It features nearly floor-to-ceiling windows overlooking Lake Michigan, the City Skyline and the John Hancock building. Frank Lloyd Wright 1 and 2 is perfect for business meetings, cocktail hours, formal occasions, social dinners and more.

## **ADLER BOARDROOM**

The Adler Boardroom faces west and features nearly floor-to-ceiling windows with views of beautiful downtown Chicago. This power boardroom has plug and play capabilities with a 70" inset Plasma. It's perfect for teleconference needs with built-in speakers. The Adler Boardroom is ideal for smaller business meetings and intimate dinners overlooking Chicago's city lights.

## **BUCKINGHAM BOARDROOM**

The Buckingham Boardroom is undoubtedly the premier meeting space at the Mid-America Club. Facing east, it features a power boardroom table with views of Navy Pier and Lake Michigan – the best views in town! The Buckingham Boardroom is the ideal spot for business meetings and small dinners.

## **FRANK LLOYD WRIGHT 3**

Frank Lloyd Wright 3 is a flexible event space facing east featuring views of Navy Pier and Lake Michigan. This is a great space for casual business meetings, training sessions, and intimate receptions and dinners.

## **MIES VAN DER ROHE & LOUIS H. SULLIVAN**

These two spaces have a fantastic view of Navy Pier and Lake Michigan. They are perfect for small meetings, intimate dinners, green room, interviews and more!

**Contact your Private Event Directors today!**

200 East Randolph Drive 80<sup>th</sup> Floor, Chicago, IL 60601 312.861.1100 [midamclub.com](http://midamclub.com)

# Mid-America Club Private Event

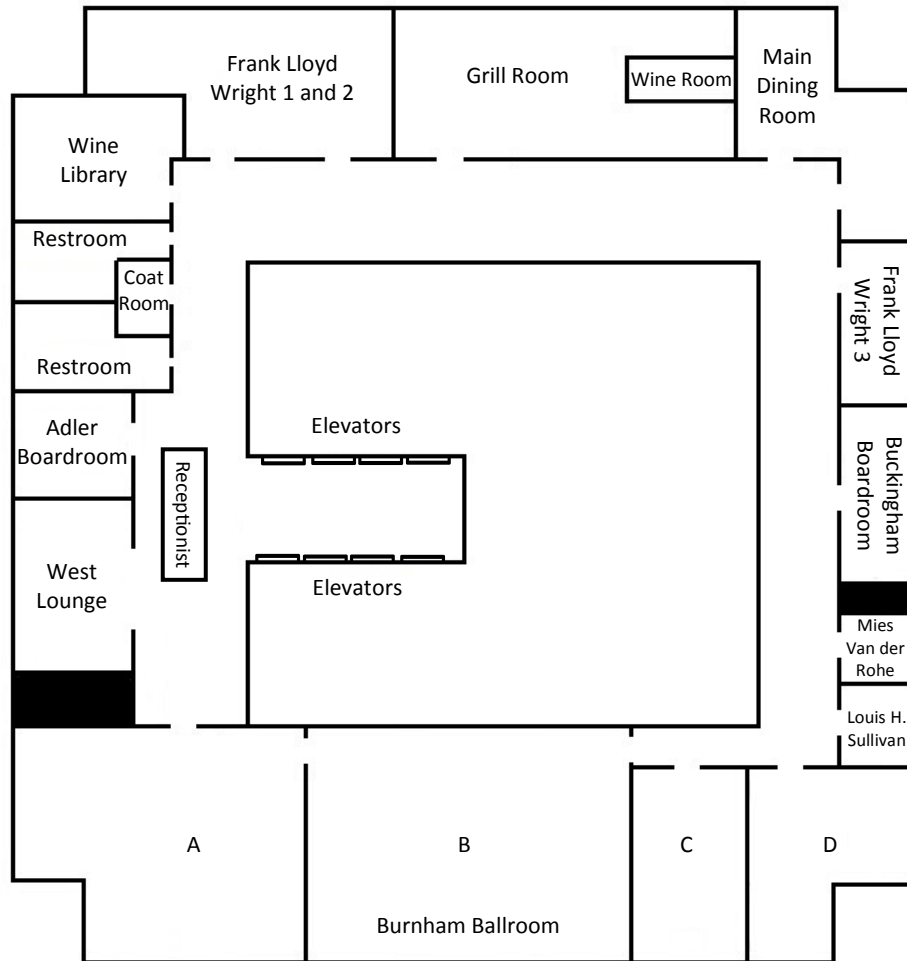

Room	Room Size	Square Ft	Conference	Classroom	Theatre	U-Shape	Reception	Rounds of 10	Crescent of 6
Burnham Ballroom	45' x 185'	8325	150	400	700	-	1000	500	258
Burnham Ballroom A	45' x 60'	2700	40	120	300	60	200	140	90
Burnham Ballroom B	45' x 65'	2925	60	140	300	80	350	150	90
Burnham Ballroom C	36' x 25'	900	30	40	80	30	60	60	36
Burnham Ballroom D	36' x 35'	1260	30	50	100	30	100	80	48
Burnham Ballroom A & B	45' x 125'	5625	60	260	500	90	550	350	210
Burnham Ballroom B, C & D	45' x 125'	5085	70	270	500	125	500	350	210
Burnham Ballroom C & D	45' x 60'	2700	40	100	200	44	200	120	72
Frank Lloyd Wright 1	30' x 30'	900	30	30	50	22	50	50	36
Frank Lloyd Wright 2	20' x 30'	600	30	30	50	26	30	50	36
Frank Lloyd Wright 1 & 2	50' x 30'	1500	36	80	120	33	150	90	54
Frank Lloyd Wright 3	15' x 32'	480	20	18	40	12	30	30	18
Library	30'x30'	900	24	30	50	20	60	50	30
Adler Boardroom	20'x20'	400	10	-	-	-	-	-	-
Buckingham Boardroom	15' x 28'	420	20	-	-	-	-	-	-
Mies van der Rohe	15' x 12'	180	6	-	-	-	-	-	-
Louis H. Sullivan	15' x 12'	180	6	-	-	-	-	-	-